

# CE-BSS Series

Miniature High Capacitance

5.4mm Height



- Solvent proof (within 2 minutes)

## Specifications

Items	Condition	Specifications						
Rated voltage (V)	—	6.3	10	16	25	35	50	
Surge voltage (V)	Room temperature	8.0	13	20	32	44	63	
Category temperature range (°C)	—	-40 to +85						
Capacitance tolerance (%)	120Hz/20°C	M : ±20						
Dissipation Factor (tan δ)	120Hz/20°C	0.28	0.24	0.20	0.16	0.14	0.12	
Leakage current (LC)	μA/after 2minutes (max)	The greater value of either 0.01CV or 3						
Impedance ratio at low temperature	Based the value at 120Hz, +20°C	-25°C Z/Z <sub>20°C</sub>	4	3	2	2	2	2
		-40°C Z/Z <sub>20°C</sub>	10	8	6	4	4	4
Endurance	85°C, 2,000hrs. rated voltage applied (With the rated ripple current)	ΔC/C	Within ±25% of the initial value					
		tan δ	≤ 2 times the initial specified value					
		LC	≤ The initial specified value					

## Marking, Dimensions

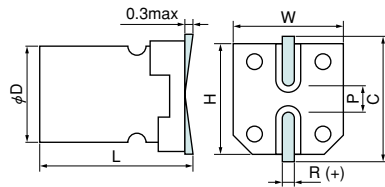
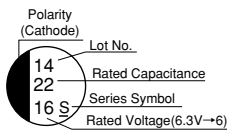

(Unit : mm)

D <sup>+0.5max</sup>	L <sup>+0.1 0.2</sup>	W <sup>±0.2</sup>	H <sup>±0.2</sup>	C <sup>±0.2</sup>	R	P <sup>±0.2</sup>
4	5.4	4.3	4.3	5.0	0.5 to 0.8	1.0
5	5.4	5.3	5.3	6.0	0.5 to 0.8	1.4
6.3	5.4	6.6	6.6	7.3	0.5 to 0.8	2.2

## Size List, Rated Ripple Current

μF	V		6.3		10		16		25		35		50	
	4.7													
10									4×5.4	20	4×5.4	20	5×5.4	27
22				4×5.4	28	4×5.4	28	5×5.4	35	5×5.4	36	6.3×5.4	40	
33			4×5.4	31	4×5.4	32	5×5.4	40	5×5.4	42	6.3×5.4	58		
47			4×5.4	36	5×5.4	43	5×5.4	44	6.3×5.4	65	6.3×5.4	65		
56			5×5.4	46	5×5.4	46	5×5.4	48	6.3×5.4	68				
100			5×5.4	47	5×5.4	50								
150			6.3×5.4	71	6.3×5.4	76								
220			6.3×5.4	74										

Please refer to page 15 for the ripple current frequency coefficient.

Rated ripple current  
mA Arms (120Hz, 85°C)

Case size: φD×L (mm)

## Model No.

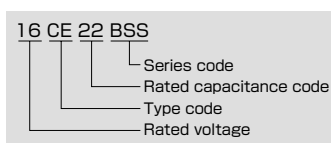

- CE-BJ
- CE-BE
- CE-BD
- CE-BSS
- CE-BS
- CE-FE
- CE-FD
- CE-LD
- CE-FSS
- CE-FU
- CE-FS
- CE-FH
- CE-GA
- CE-AX
- CE-KX
- CE-LX
- CE-LS
- CE-LH
- CE-LL
- CE-PC
- CE-PH
- CE-NP
- CE-FN
- ME-SWB
- ME-UZ-SZ
- ME-UAX-SAX
- ME-LS
- ME-HC
- ME-CZ
- ME-CA
- ME-CX
- ME-AX
- ME-WX
- ME-WA
- ME-WL
- ME-SWG
- ME-WG
- ME-PX
- ME-HPC-HPD
- ME-FC-FD
- ME-FAZ
- ME-FH
- ME-SWN
- ME-HWN